

The background of the slide is a deep blue space filled with numerous stars and a faint nebula. On the right side, a large, reddish-brown planet, likely Mars, is partially visible, showing its textured surface and polar ice caps. The text is overlaid on this background.

**NASA/MARSHALL SPACE  
FLIGHT CENTER**

**JOINT COUNSELING SESSION**

***CAD / CAM Services***  
***Scott Shuppert***

***2-22-2014***

# Background

<b>COMPANY NAME:</b>	<b>CAD / CAM Services</b>	<b>ADDRESS:</b>	1529 Brook Lane, Celina, TX 75009
<b>OWNER:</b>	Scott Shuppert	<b>CONTACT NAME:</b>	Scott Shuppert
<b>EMAIL:</b>	<a href="mailto:scott@cadcam.org">scott@cadcam.org</a>	<b>YEARS IN BUSINESS:</b>	35
<b>CAGE CODE:</b>	1ERF2	<b>DUNS NUMBER:</b>	60112-9034
<b>WEB SITE:</b>	<a href="http://www.cadcam.org">www.cadcam.org</a>	<b>NAICS CODES:</b>	541330, 541340, 561320, 518210, 332216, 333249, 334513

**CERTIFICATIONS (e.g., ISO 9001, AS 9100, etc.):**

AS-9102

# Business Size & Classifications

<b>EMPLOYEES (range):</b>	<b>54</b>
<b>AVERAGE SALES (range):*</b>	<b>\$ 2 million +</b>

<b>CLASSIFICATIONS (select from list below):</b>	<b>Yes/No</b>
<b>SMALL BUSINESS</b>	
<b>SMALL DISADVANTAGED BUSINESS</b>	
<b>NATIVE AMERICAN-OWNED</b>	
<b>ALASKAN NATIVE CORPORATION</b>	
<b>WOMEN OWNED</b>	
<b>ECONOMICALLY DISADVANTAGED WOMEN OWNED</b>	Yes
<b>VETERAN-OWNED</b>	
<b>SERVICE DISABLED VETERAN OWNED</b>	
<b>HUBZONE CERTIFIED</b>	
<b>8(A) CERTIFIED</b>	
<b>8(A) EXPIRATION DATE (if applicable)</b>	

\*Based around NAICS 541XXX



# Primary Capabilities

- **3D Engineering and Design**
- **Point Cloud Data to 3D CAD**
- **CATIA/SolidWorks/Siemens NX/PTC Creo CAD Services**
- **Reverse Engineering**
- **Mylar Blueprints to CATIA 3D Models**
- **CAD Engineering Simulation**
- **CAD Migration Services**
- **CAD Conversion Services**
- **Legacy to 2D and 3D CAD**
- **3D Designs to Sheet Metal Shop Drawings**
- **Electrical CAD**
- **3D Scanning Services**
- **Loft Book Data Processing**
- **ITAR – GSA – DLA registered**



# Current and Recent Contracts/Performance ( < 5 years )

- Amazon.com - 1,000,000 3D CAD files
- The Navy – 900' Sealift vessel
- Central Arizona and Memphis Power and Light, 5-year 40,000 & 55,000 Legacy to CAD projects (ongoing)
- Astra Aerospace – Space rocket engine design
- LeoStella – Hypersonic missile electrical harness design
- B737 - Point Cloud to CAD Model
- FLIR – UAV Engineering Drawings & Military Robotics
- Kaman Aerospace – F-15 Fuselage, Wing, Stabilizer – Parts Models Over Legacy Blueprints and Loft Book Data
- Crane Aerospace – Convert SolidWorks models to CATIA following Airbus standards. AS-9102 reports generated.



# NASA Value - Quad Chart





# Awards/Notable Accomplishments

## amazon

1,000,000+ 3D drawings

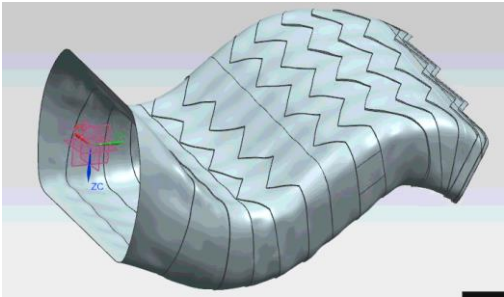

Stealth fighter  
268 J-size Mylars to Catia

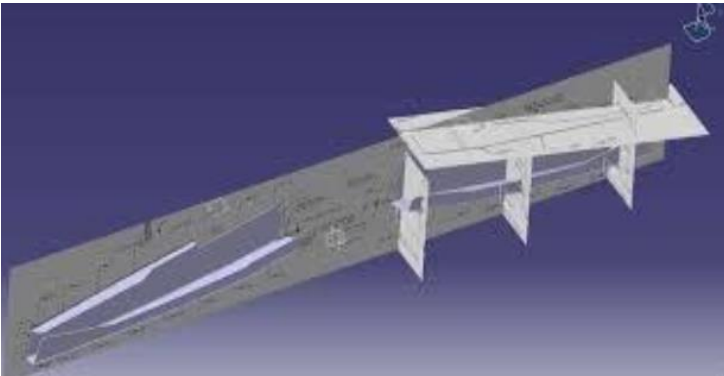

Trademarks  
CAD Perfect™  
CAD Perfect CAD Conversions™ 7



# Possible Services To NASA

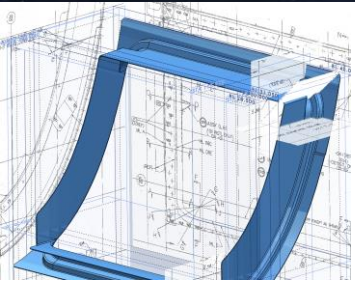

**Catia ⇔ Siemens NX ⇔ PTC Creo ⇔  
Solidworks ⇔ Inventor**  
**Feature rich – CAD Perfect™ CAD Translations**

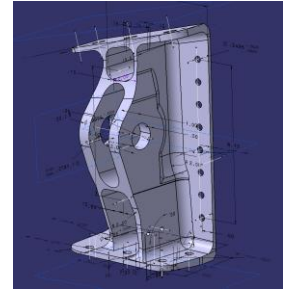

**3D CAD Modeling and Legacy conversion to Catia**  
**Mylar -> intelligent, feature rich \*.CATPart, and \*.CATProduct**

**50-year storage of CAD data**  
**STEP-242**

**Metadata-3D Mechanical & PMI-PDM-Electrical Harness**  
**Model based Engineering-Analysis**  
**Based on Lotar / Pedes standards**

**Metrology scanning services and scanners/CMM**  
**Creaform and Hexagon**

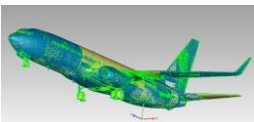

3D scan -> 737 -> Catia





# Why CAD / CAM Services

We understand the difference of 3D Modeling – 3D Engineering – Model Based Definitions – Digital Twins, and Shop drawings



The understanding of live use of complex CAD extensions. Here is an intelligent Creo Schematic linked with Siemens Capital

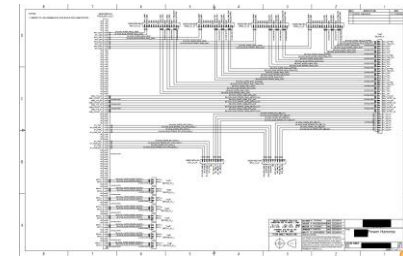

Think of a Tesla S competitor for 2025. Here is a Catia 3D electrical wiring harness design for the electric autonomous car that ties in with Siemens Capital.

# Principle Point(s) of Contact

<b>NAME</b>	<b>TITLE</b>	<b>PHONE</b>	<b>EMAIL</b>
<b>Scott Shuppert</b>	Owner	972-978-4288	scott@cadcam.org
<b>John Green</b>	Technical Engineer	972-978-4288	john@cadcam.org
<b>Nic Rady</b>	Sales Engineer	972-978-4288	nic@cadcam.org

